

**ESL Fixtures**  
**SOLUM**  
Solution provider.



# *Fitting Solutions for Electronic Price Labeling (ESL)*



***METO***<sup>®</sup>

your retail label expert



## METO – YOUR HANDS-ON PARTNER

**Meto** sees itself as a supplier of quality products and a partner to retail, industry and the service sector.

Headquartered in Hirschhorn am Neckar, as a market leader we draw on decades of experience and close cooperation with our customers to develop and realise innovative and customized concepts which set the benchmark in retail today.

Our integrated system solutions and first-class services provide for a smooth flow of goods throughout the supply chain.

Since 2016, **Meto** has been a part of CCL Industries Inc., a market leader in the field of labeling and packaging solutions for companies and consumers.

## MORE THAN JUST SELLING OF PRODUCTS

**Meto** not only supplies its products in proven quality. Its services extend well beyond this:

- Advice for customers in identifying requirements and corresponding solutions
- Support in the development, design and technical implementation of individual solutions
- Production of prototypes and samples

## QUALITY “MADE IN GERMANY”



We are certified in accordance with numerous recognized standards, such as

- ISO 9001 Quality management system)
- ISO 14001 (Environmental management system)
- ISO HACCP (Professional Food management system)
- BRCS (Hygiene management system)



## BLISTER HOOKS

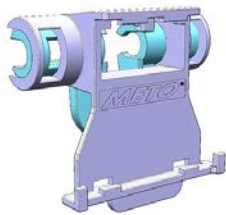

### Blister Hook Adapter M2 1.6", 2.2", 2.7", 2.9", 3.3"

Adjustable in 3 angles with swing-back mechanism.

Fits on most metal and plastic blisterhooks/pins types and brands up to 4 – 5 mm thickness (please test with sample).

Consists out of 2-parts: 1 for metal hook, 1 for ESL. Will combined and installed as one.

Fit at the ESL battery case.

Art. no.	Color	UQ
9501007	transparent	100
30001984	black	100

Material: PC

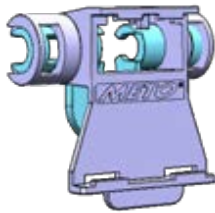

### Blister Hook Adapter NEWTON M2 1.6", 2.2", 2.7", 2.9", 3.3"

Adjustable in 3 angles with swing-back mechanism.

Fits on most metal and plastic blisterhooks/pins types and brands up to 4 – 5 mm thickness (please test with sample).

Consists out of 2-parts: 1 for metal hook, 1 for ESL. Will combined and installed as one.

Fit at the ESL battery case.

Art. no.	Color	UQ
30007417	transparent	100

Material: PC



## BLISTER HOOKS / SHELF RAILS



### SOLUM ESL BlisterHook extension

To place 2 1.6 M2 ESL side by side at the front of the Blister Hook Adapter M2 Art. 9501007 or 30001984.

Art. no.	Color	UQ
	black	

Material: PVC

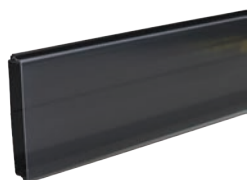

### Universal Rail M1/M2 4.2''

In combination with adapter plate large art. no. 9488908.

Closed rail to protect ESL. Transparent front can be folded upwards.

With double sided tape, to add on a flat surface. Usually used in fruit & vegetable department. Rear side black RAL 9005.

Art. no.	Length	Color	UQ
30002061	1,000 mm	jet black RAL 9005	5
30002062	1,200 mm	jet black RAL 9005	5
30002063	1,240 mm	jet black RAL 9005	5
9498415	1,200 mm	gray aluminum RAL 9007	5
9478499	1,240 mm	gray aluminum RAL 9007	5

Material: PVC

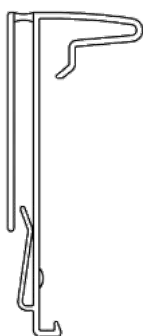

### SOLUM NEWTON Universal rail with tape, flexible

With 1 stripe 15 mm tape CP5108. With Smart-Grip, to place and take out ESL by one hand.

Utility patent: 202021100459.2

Art. no.	Length	Color	UQ
30009123	995 mm	transparent	50
30009124	550 mm	transparent	50
30009125	30 mm	transparent	50
30009126	635 mm	transparent	25
30009127	290 mm	transparent	25

Material: PVC

## SHELF RAILS



### SOLUM NEWTON Universal rail with tape, not flexible

With 1 stripe 15mm tape CP5108. With Smart-Grip, to place and take out ESL by one hand. Utility patent: 202021100459.2

Art. no.	Length	Color	UQ
	1,250 mm	antracite gray RAL 7016	50

Material: PVC



### SOLUM NEWTON/M2 Universal rail with tape, flexible

The ESL will be inserted direct into the rail. With 1 stripe of 15mm tape. Adjustable With Crownner insert at the below side.

Art. no.	Length	Color	UQ
30006582	1,238 mm	white aluminum RAL 9006	50
30006583	988 mm	white aluminum RAL 9006	50
30008069	1,248 mm	traffic grey B RAL 7043	25
30008169	1,248 mm	traffic grey B RAL 7043	50
30008083	1,250 mm	transparent	50
30008084	988 mm	transparent	50

Material: PVC



### Double rail with tape

With 25mm double sided, strong tape to fit 2 SOLUM Universal rails with tape on top of each other.

Art. no.	Length	Color	UQ
30009071	1,238 mm	transparent	25

Material: PVC



## SHELF RAILS

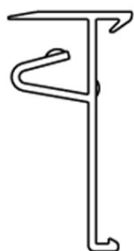

### Glass Rail N M2/NEWTON

The ESL will be inserted direct into the rail. To attach at 4 – 6 mm glass shelves.

Art. no.	Length	Color	UQ
30001985	1,000 mm	graphite black RAL 9011	50
30006693	985 mm	graphite black RAL 9011	50
30006694	940 mm	graphite black RAL 9011	50
30006695	970 mm	graphite black RAL 9011	50
30006696	910 mm	graphite black RAL 9011	50
30006697	510 mm	graphite black RAL 9011	50

Material: PVC

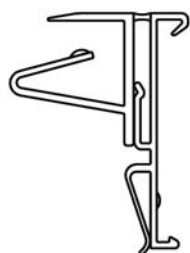

### Glass Rail Flexible M2/NEWTON, flexible

The ESL will be inserted direct into the rail. To attach at 4 – 8 mm glass shelves.

Art. no.	Length	Color	UQ
on request	1,000 mm	transparent	50

Material: PVC

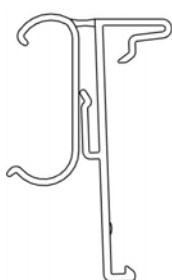

### Epta/Bonnet Rail M2/NEWTON, flexible

The ESL will be inserted direct into the rail. Adjustable with optional incliner Art. No. 30005333.

With Smart-Grip, to place and take out the ESL by one hand.

Utility patent: 202021100459.2

Art. no.	Length	Color	UQ
on request	x,xxx mm	transparent	50

Material: PVC

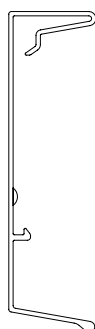

### SOLUM Newton Tape-bumper rail 57mm M2/NEWTON

To protect the ESL against a soft front impact. With 2 stripes of 15mm adhesive tape. With Smart-Grip, to place and take out ESL by one hand.

Utility patent: 202021100459.2

Art. no.	Length	Color	UQ
30007896	1,000 mm	traffic grey B RAL 7043	50

Material: PVC

## SHELF RAILS



Version left



Version right

### SOLUM EndCap for NEWTON Tape-bumper rail 57 mm with Smart-Grip

Will cover the rail on the end sides 2 pieces needed, one for the right and one for the left end of the rail.

Art. no.	Color	UQ
30007951	traffic grey B RAL 7043	50

Material: ABS



### SOLUM NEWTON Tape rail 57 mm with Smart-Grip

The ESL will be inserted direct into the rail. Fits on shelves with 57mm height flat front. With 2 stripes of 15mm adhesive tape. With Smart-Grip, to place and take out ESL by one hand. Utility patent: 202021100459.2

Art. no	Length	Color	UQ
30007887	1,250 mm	traffic grey B RAL 7043	50

Material: PVC



Version left



Version right

### SOLUM EndCap for NEWTON Tape-rail 57mm with Smart-Grip

Will cover the rail on the end sides. 2 pieces needed, one for the right and one for the left end of the rail.

Art. no.	Color	UQ
30007953	traffic grey B RAL 7043	50

Material: ABS

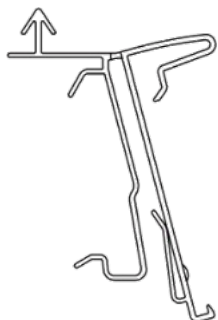
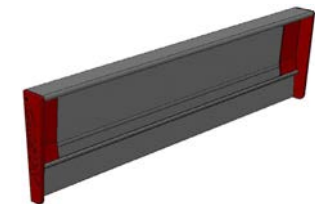

### SOLUM NEWTON Tego rail, flexible

With Crowner insert at the below side. UV-resistant. With arrow to fit shelf dividers. With Smart-Grip, to place and take out ESL by one hand. Utility patent: 202021100459.2

Art. no	Length	Color	UQ
30009129	986 mm	transparent	50
30009130	1,238 mm	white aluminum RAL 9006 transparent	50

Material: PVC

## SHELF RAILS

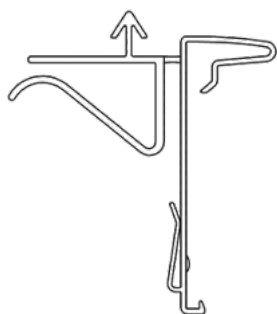

### SOLUM NEWTON Glass shelf rail, flexible

To fit at 6-8mm Glass shelves. With Crowner insert at the below side.  
To attach at 4-8 mm glass shelves.  
With arrow to fit shelf dividers. With Smart-Grip, to place and take out ESL by one hand. Utility patent: 202021100459.2

Art. no	Length	Color	UQ
30009122	775 mm	transparent	50

Material: PVC

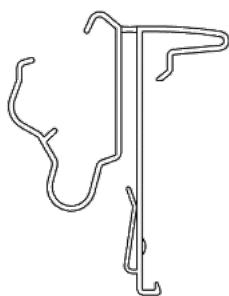

### SOLUM NEWTON TLS rail, flexible

Adjustable in 2 angles. With Crowner insert at the below side. With Smart-Grip, to place and take out ESL by one hand.

Utility patent: 202021100459.2

Art. no	Length	Color	UQ
30009128	995 mm	transparent	50

Material: PVC

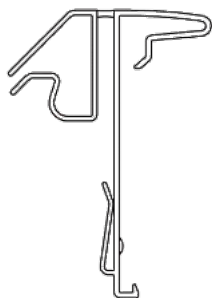

### SOLUM NEWTON Wire basket rail, flexible

To fit at angled wire baskets. With Crowner insert at the below side. With Smart-Grip, to place and take out ESL by one hand.

Utility patent: 202021100459.2

Art. no	Length	Color	UQ
30009131	980 mm	transparent	25

Material: PVC



### SOLUM NEWTON/M2 Freezer Clamp rail

Art. no	Length	Color	UQ
30008279	720 mm	light grey RAL 7035	50
30009338	60 mm	slate grey RAL 7015	50

Material: PVC



## SHELF RAILS

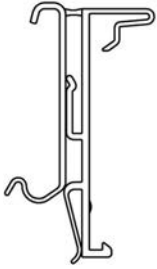

### Tego / Hauser Rail M2/NEWTON, flexible

The ESL will be inserted direct into the rail. Fit on Tego/Hauser shelves.  
Adjustable with optional incliner Art. no. 30005333. With Smart-Grip, to place and take out ESL by one hand.  
Utility patented no. 202021100459.2

Art. no.	Length	Color	UQ
30007416	1,235 mm	antracite gray RAL 7016	50

Material: PVC

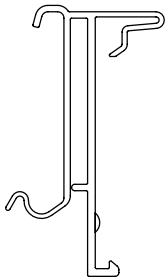

### SOLUM NEWTON Tego/Hauser rail, not flexible

With Smart-Grip, to place and take out ESL by one hand.  
Utility patent: 202021100459.2

Art. no.	Length	Color	UQ
	1,235 mm	antracite gray RAL 7016	50

Material: PVC

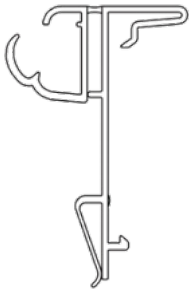

### SOLUM NEWTON Wanzl rail, flexible

With Smart-Grip, to place and take out ESL by one hand.  
Utility patent: 202021100459.2

Art. no.	Length	Color	UQ
30011281	977 mm	transparent	50

Material: PVC



### SOLUM NEWTON 1.6" / 2.2"

Cover rail with on 15mm double side adhesive strip at the rear side, with transparent front cover. With Smart-Grip, to place and take out ESL by one hand.

Utility patent: 202021100459.2

Art. no.	Length	Color	UQ
30009351	1,000 mm	transparent/black	1

Material: PVC

## SHELF RAILS



### Clamp Rail M2/NEWTON

To attach at existing paper rail from below. Paper tag rails can be used in combination with ESL. Direct insert of the ESL. For paper rails with 40 mm height.

Utility patented no. 20 2017 106 211 72

Art. no.	Length	Color	UQ
30003137	70 mm	transparent	50

Material: PVC

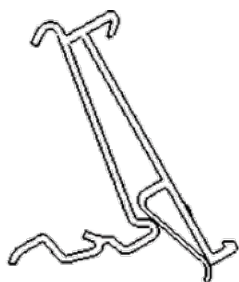

### SOLUM NEWTON/M2 Tego special rail, not flexible

The ESL will be inserted direct into the rail. Fit on both Tego special shelves. Adjustable in 2 positions. With Crowner insert at the below side.

Utility Patent: 20 2020 106 905

Art. no.	Length	Color	UQ
30006579	1,238 mm	white aluminum RAL 9006	50
30006580	988 mm	white aluminum RAL 9006	50
30006581	758 mm TK	white aluminum RAL 9006	50

Material: PVC

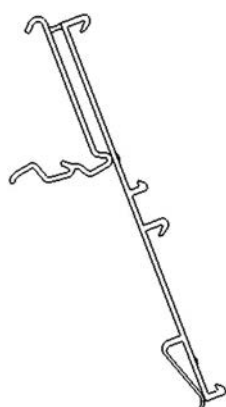

### Tego / Storebest Double Rail M2/NEWTON

The ESL will be inserted direct into the rail. Fit on Tego/Storebest shelves. 2 ESL 2.9" can be placed one above the other.

Utility Patent: 20 2020 106 905

Art. no.	Length	Color	UQ
30007414	1,215 mm	dusty grey RAL 7037	50

Material: PVC

## FOOD STANDS

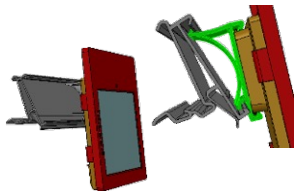

### SOLUM NEWTON angled rail

To place onto the SOLUM Newton/M2 Tego special rail.

Art. no.	Length	Color	UQ
30008654	60 mm	transparent	50

Material: PVC

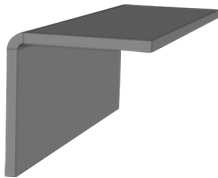

### Incliner/L\_Angle 45°

To place at the rear side of the front rail to adjust rail in angled position.

Art. no.	Length	Color	UQ
30005333	12,7x12,7x35 mm	transparent	50

Material: 1mm PVC



### Footstand Large, Adjustable M2 4.2", 6.0", 7.5"

Fit 7.5" ESL in portrait way, 4.2" & 6.0" in landscape way.

Adjustable in 3 angles: 14°, 27° and 40°.

Art. no.	Adjustable angles	Color	UQ
30001270	14°, 27° and 40°	white	25

Material: ABS



### Small Transparent Stand

To be used in service counters (deli, meat, cheese etc.) .

To use in combination with adapter plate Art. no. 9484502.

Art. no.	Height from below ESL	Color	UQ
8327200	5 cm	transparent	25
8327201	10 cm	transparent	25
8328007	15 cm	transparent	25

Material: SAN

## ADAPTER PLATES



### Stand 11.6"

Stand will fit the ESL in portrait, incl. 4 screws M3x5mm DIN 7985  
Art. no. 30003347 (to fit plate at ESL).

Art. no.	Color	UQ
30003390	transparent	

Material: PETG



### Wall Mounting, Magnet 11.6"

The Plate will fit the ESL in portrait at flat magnetic surfaces, with strong magnet 130 x 67 x 2 mm, incl. 4 screws M3x5mm DIN 7985 Art. no. 30003347 (to fit plate at ESL).

Art. no.	Color	UQ
30003349	transparent	10

Material: PETG



### Button Head Screw M3x5 MM DIN 7985

To fit the 11.6 to the Stand or Wall mounting.

Art. no.		UQ
30003347		

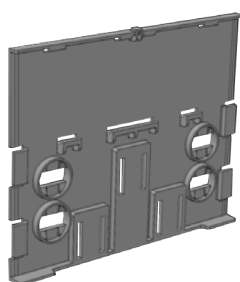

### Adapter Plate, Large M2 4.2", 6.0", 7.5" & NEWTON

Click the plate directly on the battery cap. With intergrated card inserts for promotions.

Art. no.	Color	UQ
30003158	transparent	25

Material: PC

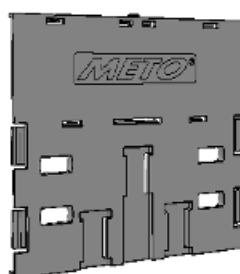

### SOLUM NEWTON Adapterplate large - adhesive 4.2" - 6.0" - 7.5"

Click the plate directly on the battery cap. With intergrated card inserts for promotions. With double sided tape to fit at various surfaces.

Art. no.	Color	UQ
30001258	transparent surfaces	100

Material: PC

## ADAPTER PLATES

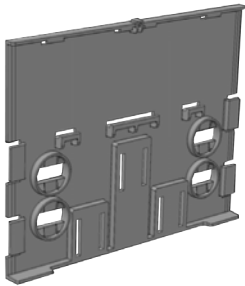

### Adapter Plate, Large M2 4.2", 6.0", 7.5" & NEWTON with Magnetic Tape

Click the plate directly on the battery cap. With integrated card inserts for promotions. With strong magnet plate to fit at (magnetic) metal surfaces.

Art. no.	Color	UQ
30003159	transparent	25

Material: PC, magnet

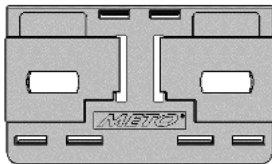

### SOLUM NEWTON Adapterplate small

Click the plate directly on the battery cap. With integrated card inserts for promotions.

To fit different METO clips with METO insert.

Art. no.	Color	UQ
30006573	transparent	50

Material: PC

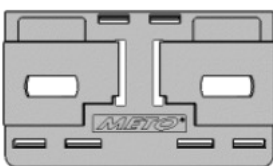

### SOLUM NEWTON Adapterplate small - adhesive

Click the plate directly on the battery cap. With integrated card inserts for promotions.

With 15mm double sided adhesive tape.

Art. no.	Color	UQ
30007419	transparent	25

Material: PC

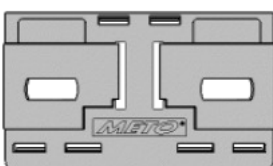

### SOLUM NEWTON Adapterplate small - magnetic

Click the plate directly on the battery cap. With integrated card inserts for promotions.

Art. no.	Color	UQ
30006792	transparent	25

Material: PC



# Modular and individual combinable

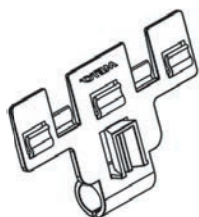

chalkboard plus  
date cassette

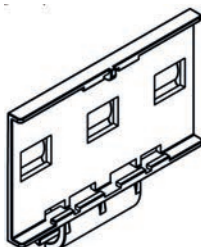

Solu M  
Newton

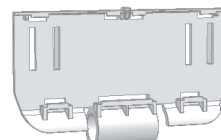

Solu M  
M2 + Newton

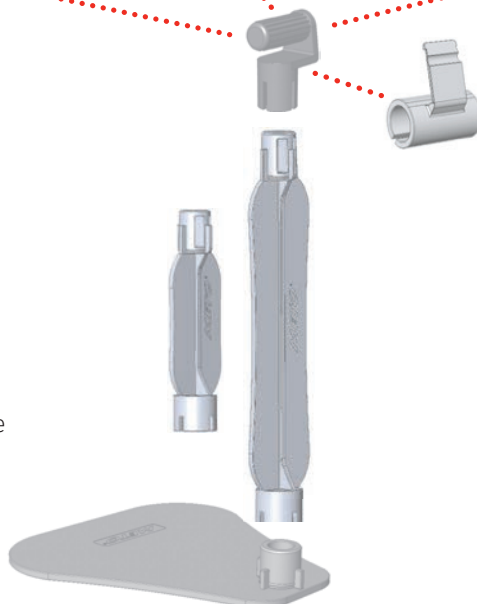

The METO counter range  
is dishwasher safe.



Please scan the QR Code for the  
application video on Youtube.

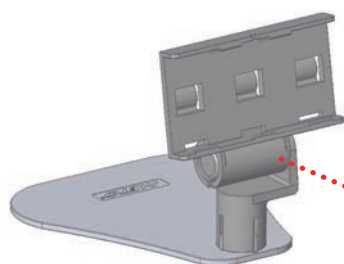

stable detent,  
horizontalyl in 5 angles  
adjustable

available in 3 heights



20 mm



50 mm

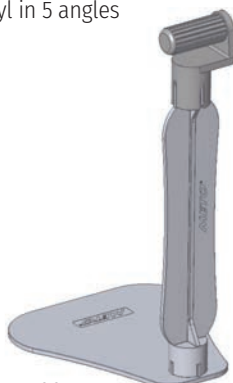

100 mm

vertically adjustable by 90°





## METO – COUNTERLINE

Your counter -> your customer magnet / your passion / your future

Whether manually with cassettes, cards, paper or digitally with ESL (electronic price tags). No matter what labeling you use on your counter. With the new **METO CounterLine** ESL fastening system you have always the right fastenings at hand.

- Simple, modular plug-in system
- Can be combined in many ways with various METO fastening parts
- Fits with printed cards, METO cassettes, ESL (Hanshow/SOLUM, SES Imagotag)
- Can be adjusted horizontally (90° steps) and vertically (5 locking points)
- Adjustable in 3 heights (20, 50 & 100 mm)
- Stable & robust, united in a slim design
- Food safe & dishwasher safe
- Color: transparent (RAL colors on request)

## CLAMPS & CLIPS

### Footstand

Base Plate 85x80mm. To place the extension arms (50 or 100mm).  
Adjustable 90° vertically incl. adjustable connector to add different ESL  
adjustable adapter.

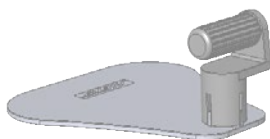

Art. no.	Length	Color	UQ
30008987	85 x 80 mm	transparent	25

Material: PC

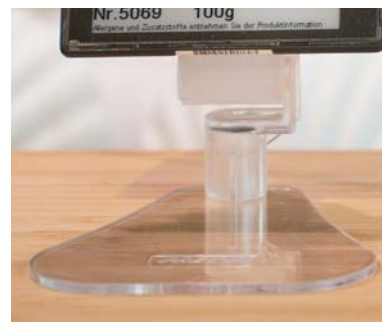

### Footstand

Extension Arm 50mm. Adjustable 90° vertically. To attach to the Base Plate.



Art. no.	Length	Color	UQ
30008988	50 mm	transparent	25

Material: PC



### Footstand

Extension Arm 100mm. Adjustable 90° vertically. To place the Base Plate.



Art. no.	Length	Color	UQ
30009020	100 mm	transparent	25

Material: PC



### Bowl Clamp

To attach the ESL to bowls and boxes. Adjustable 90° vertically  
incl. adjustable connector to add different ESL adjustable adapter.



Art. no.	Color	UQ
30009540	transparent	25

Material: PC



## CLAMPS & CLIPS



### Ice Spit

To put the ESL in a crushed ice presentation (e.g. fresh fish). Adjustable 90° vertically incl. adjustable connector to add different ESL adjustable adapter.

Art. no.	Color	UQ
30009435	transparent	25

Material: PC

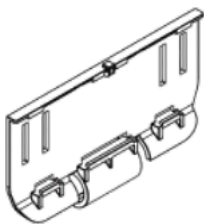

### SOLUM M2 Adjustable AdapterPlate 2.9"-7.4"

To use in combination with different METO Clamps like 9486983, 9484255 & 9515937.

Art. no.	Color	UQ
30000706	transparent	25

Material: PC

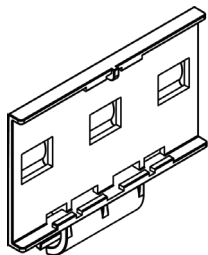

### SOLUM NEWTON Adjustable adapter to combine with foot stand for service counter

To use in combination with METO adjustable clamps 9486983, 9484255, 9505167 (remove METO clip before) and the new CounterLine Footstand 30008987.

Art. no.	Color	UQ
30009024	transparent	25

Material: PP



### Clamp with Adjustable Adapter, Insert

To use in combination with Meto adjustable clamps & Meto adapter plates.

Art. no.	Color	UQ
9486983	transparent	25

Material: PC



## CLAMPS & CLIPS



### Box Clamp with Adjustable Adapter, Insert

To use in combination with Meto adjustable clamps & Meto adapter plates.

Art. no.	Color	UQ
9484255	black	10

Material: PA / PC



### Price Label Clamp with adjustable METO Adapter

To use in combination with METO AdapterPlates Adapter can also be adjusted in 45° horizontal way.

Art. no.	Color	UQ
9505167	black	25

Material: PC



### Price Label Clamp NEWTON with Adjustable Meto Adapter

Adapter can also be adjusted in 45° horizontal way.

Art. no.	Color	UQ
30001779	transparent/black	25

Material: PA / PC



### Light Clamp

With flexible hinge and small insert for Meto adapter plates.

To use in combination with adapter plate NEWTON and Meto wide to small insert Art. no. 30006712.

Art. no.	Color	UQ
30000219	transparent	25

Material: PC, POM



## CLAMPS & CLIPS



### Meto Wide to Small Insert Adapter

To use in combination with adapter plate NEWTON for light clamp Art. no. 30000219.

Art. no.	Color	UQ
30006712	black	50

Material: POM



### Shelf Clip Tego

To use in combination with different adapter plates large or small. The shelf clip will rotate into the adapter plate. Allows to place ESL in 2 different angles. 2 pcs. per ESL needed.

Art. no.	Color	UQ
9497084	white	25

Material: POM

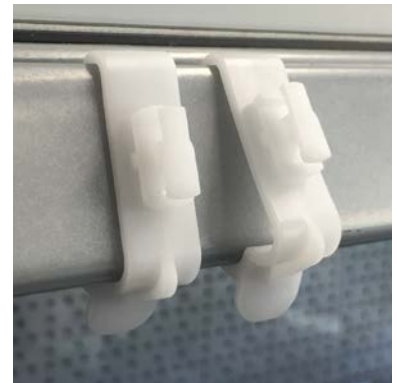

### Universal Holder

To use as a stand in combination with different adapter plate. The universal holder will rotate into the adapter plate. Allows to place the ESL in 2 different angles.

Art. no.	Color	UQ
8311485	white	25

Material: POM



### Foot Stand, Small

To use as a stand in combination with different adapter plate large. The foot stand will rotate into the adapter plate.

Art. no.	Color	UQ
9462107	transparent	25

Material: PC



## CLAMPS & CLIPS/HANGING PRESENTATION



### Unifix Roll

For shelves from 8 up to 35 mm thickness.  
Will be rotated into the adapter plate. 2 pcs per ESL needed.

Art. no.	ColorU	Q
8312162s	emitransparent, white	25

Material: PC, POM



### Suspension Hook

To use in combination with different adapter plates. 2 pcs per ESL needed.

Art. no.	Color	Dimension	UQ
8329802	white	12 mm Ø	50
8329803	white	16 mm Ø	50

Material: POM



### SuspensionHook long METO

In combination with AdapterPlate small Art. 30006573.

Art. no.	Color	Dimension	UQ
30006343	black	12 mm Ø	50

Material: POM



### Cardboard Clamp, Small

To fix the ESL on boxes. Attachment to adapter plate, small art. no. 9474056.

Art. no.	Color	UQ
9475217	transparent	50

Material: PC

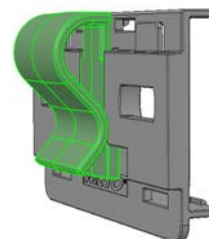

## PROMOTION & BRANDING

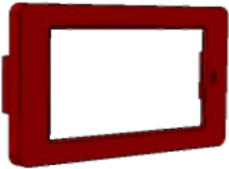

### SOLUM NEWTON SnapOn 2.6"

Can be produced in individual RAL colors and printings.

Art. no.	Color	UQ
TBD	individual	on request

Material: ABS

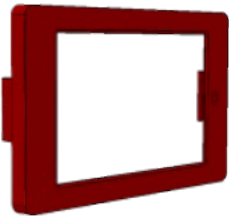

### SOLUM NEWTON SnapOn 2.7"

Can be produced in individual RAL colors and printings.

Art. no.	Color	UQ
TBD	individual	on request

Material: ABS

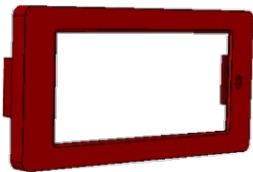

### SOLUM NEWTON SnapOn 2.9"

Can be produced in individual RAL colors and printings.

Art. no.	Color	UQ
TBD	individual	on request

Material: ABS

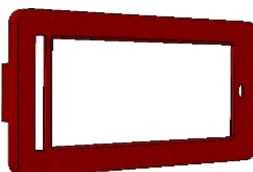

### SOLUM NEWTON SnapOn 2.9" with open space for barcode

Can be produced in individual RAL colors and printings.

Art. no.	Color	UQ
TBD	individual	on request

Material: ABS

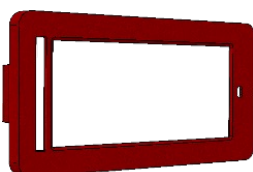

### SOLUM NEWTON light SnapOn 2.9"

Can be produced in individual RAL colors and printings.

Art. no.	Color	UQ
TBD	individual	on request

Material: ABS

## PROMOTION & BRANDING

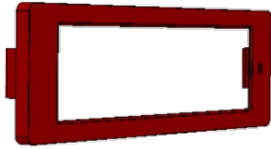

### SOLUM NEWTON SnapOn 4.3"

Can be produced in individual RAL colors and printings.

Art. no.	Color	UQ
TBD	individual	on request

Material: ABS

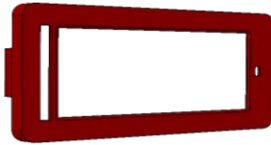

### SOLUM NEWTON SnapOn 4.3" with open space for barcode

Can be produced in individual RAL colors and printings.

Art. no.	Color	UQ
TBD	individual	on request

Material: ABS

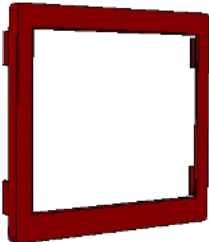

### SOLUM NEWTON SnapOn 6.0"

Can be produced in individual RAL colors and printings.

Art. no.	Color	UQ
TBD	individual	on request

Material: ABS

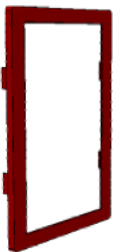

### SOLUM NEWTON SnapOn 7.5"

Can be produced in individual RAL colors and printings.

Art. no.	Color	UQ
TBD	individual	on request

Material: ABS



### SOLUM NEWTON SnapOn 8.2" with open space for barcode

Can be produced in individual RAL colors and printings.

Art. no.	Color	UQ
TBD	individual	on request

Material: ABS

## PRINTING IDEAS

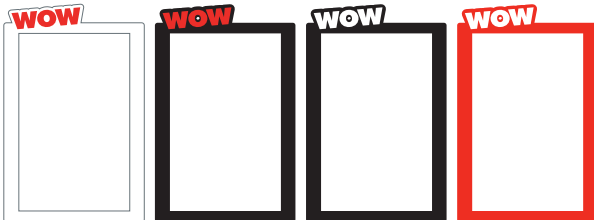

### SOLUM 7.5" ESL

Printed sticker to place around the ESL.  
Can easily be clicked onto the ESL frame.

Art. no.	Mold no.	Color CMYKU	Q
xxxxxxxxxx	xxxx.xx	Pantone xxxx	50

Material: ABS

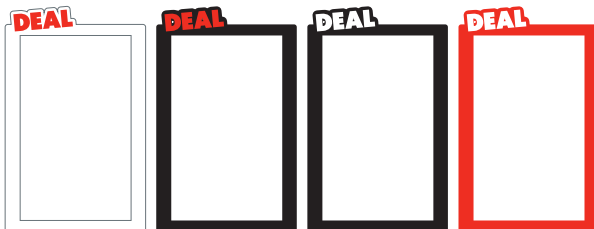

### SOLUM 7.5" ESL

Printed sticker to place around the ESL.  
Can easily be clicked onto the ESL frame.

Art. no.	Mold no.	Color CMYKU	Q
xxxxxxxxxx	xxxx.xx	Pantone xxxx	50

Material: ABS

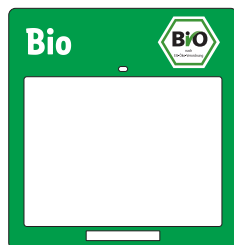

### SOLUM SnapOn 4.2 extended

With top extension to place additional information. With open space below for barcode. Printed ESL frame. Can easily be clicked onto the ESL.

Art. no.	Mold no.	Color CMYKU	Q
xxxxxxxxxx	xxxx.xx	83-13-85-1/60-9-99-0	50

Material: ABS



### SOLUM SnapOn 4.2 extended

With top extension to place additional information. With open space below for barcode. Printed ESL frame. Can easily be clicked onto the ESL.

Art. no.	Mold no.	Color CMYKU	Q
xxxxxxxxxx	xxxx.xx	32-45-79-27/12-100-98-3	50

Material: ABS

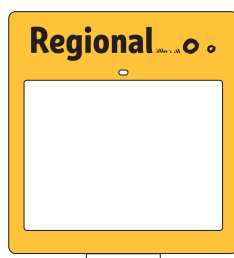

### SOLUM SnapOn 4.2 extended

With top extension to place additional information. With open space below for barcode. Printed ESL frame. Can easily be clicked onto the ESL.

Art. no.	Mold no.	Color CMYKU	Q
xxxxxxxxxx	xxxx.xx	0-25-93-1	50

Material: ABS



## PROMOTION & BRANDING

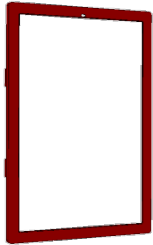

### SOLUM NEWTON SnapOn 11.6"

Can be produced in individual RAL colors and printings.

Art. no.	Color	UQ
TBD	individual	on request

Material: ABS

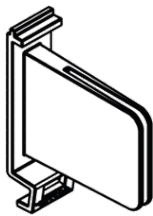

### SOLUM NEWTON Flag Holder

For Smart-Grip rails. Will be clicked in each Newton rail. To fit cards/shelf stoppers/wobblers in 90 degrees way from shelf.

Art. no.	Color	UQ
30009294	transparent	50

Material: PC

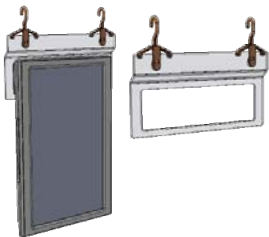

### SOLUM M2 suspension

Art. no.	Color	UQ
	transparent	on request

Material: PETG

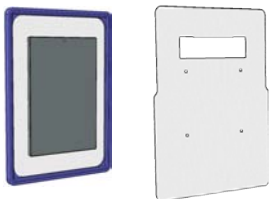

### SOLUM NEWTON 8.2"&11.6" insert, to plac inside the METO DIN A4

1 insert fits both ESL

Art. no.	Color	UQ
	transparent	on request

Material: PETG



### Beverage sign for double ESL 7.4" presentation

with DIN A5 paper insert on top 2 suspension hooks additional needed.

For double side presentation, two pcs are needed.

Art. no.	Color	UQ
	gray	on request

Material: PVC



## DIFFERENT FIXINGS



### Screw Driver TX10X80

To fit the screws at the SOLUM Newton/M2 11.6".

Art. no.	UQ
30004125	1

## METOOL



### METOOL

To lever out the ESL of the different Meto fixtures and rails.  
The tool can be used for all ESL types.

Art. no.	UQ
30000790	10

Material: PC











**KÜHNIS**  
SOLUTIONS

Einfach ausgezeichnet



---

Kühnis Solutions AG offers customers from Switzerland and Liechtenstein a variety of sales-promoting solutions for retail and industry. The company's mission is to bring electronic price labels to the shelves in the best possible way.



**Kühnis Solutions AG**

Staatsstrasse 207  
9463 Oberriet

Telefon +41 71 760 07 07

[info@kuehnis-solutions.ch](mailto:info@kuehnis-solutions.ch)  
[www.kuehnis-solutions.ch](http://www.kuehnis-solutions.ch)